

Markýza ITALIA

Základní specifikace produktu

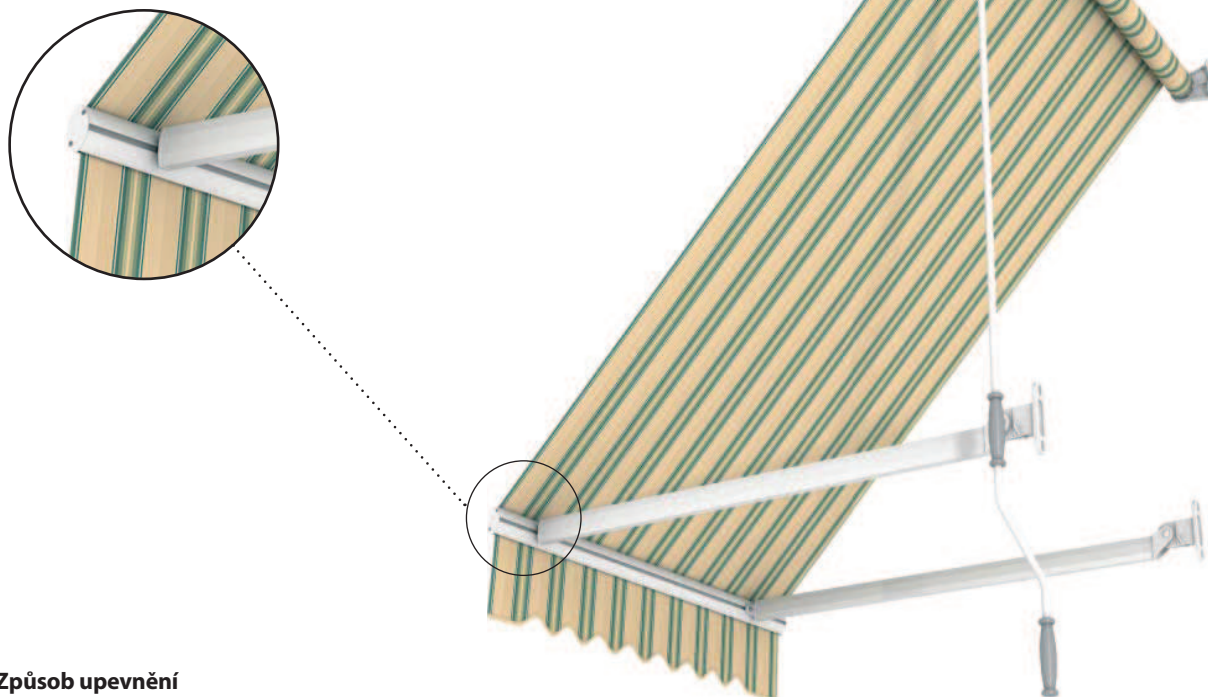

Způsob upevnění

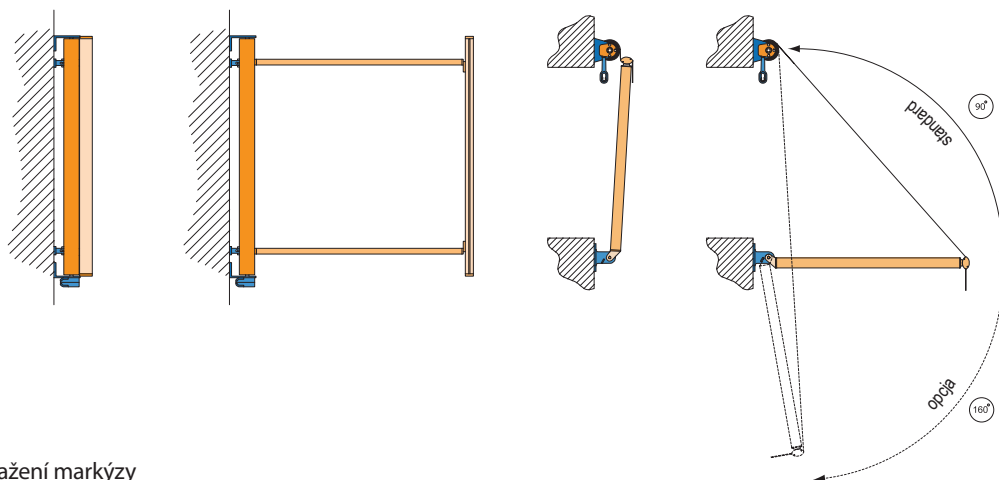

Ovládání

Slouží k vytažení a zatažení markýzy

Manuální – klika

Elektrické – motor

Specifikace

Průměr hřídele (mm)	Druh Návod na montáže	Počet držáků markýzy v závislosti na její šířce			Barva konstrukce
		do 3500 mm	do 4700 mm	do 5000 mm	
70	univerzální	2	2	2	RAL 9010 bílá

Standardní rozměry

max. výsuv (mm)	max. šířka (mm)
1000	5000
1400	
1800	

Ovládání klikou

Druh pohonu	Převodovka	Délka kliky
Převodovka s klikou (standard)	11:01	1500 mm 1800 mm 2200 mm

Ovládání motorem

Typ pohonu	Točivý moment	Pohon s adaptérem a unašečem	Nouzová ovládací klika
AXIS	30 Nm	Ano	Ne
	45 Nm / 50 Nm	Ano	Ne
AXIS-H	30 Nm	Ano	Ano
	45 Nm / 50 Nm	Ano	Ano
NEMO-H s RTS	30 Nm	Ano	Ano
	45 Nm / 50 Nm	Ano	Ano

Markýza ITALIA

Návod na montáž

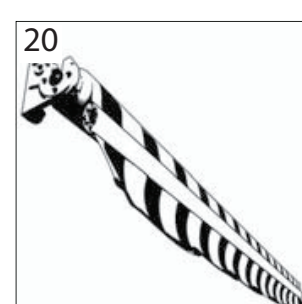
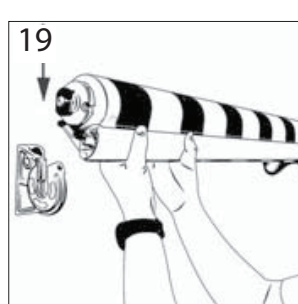
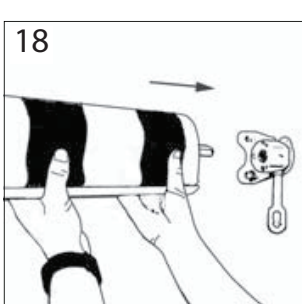
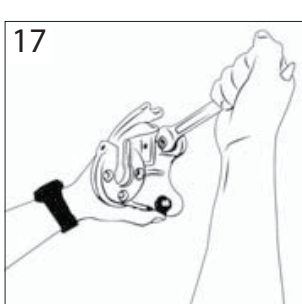
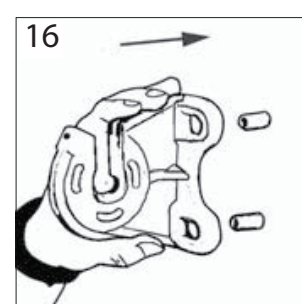
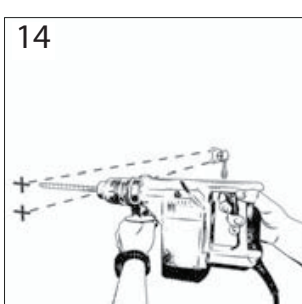
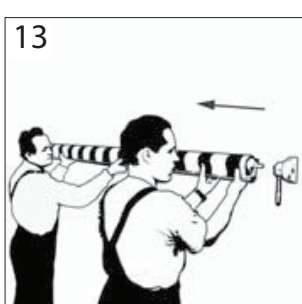
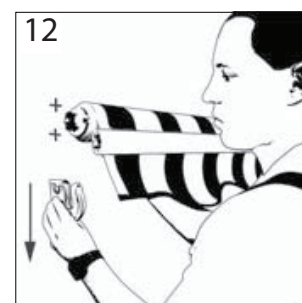
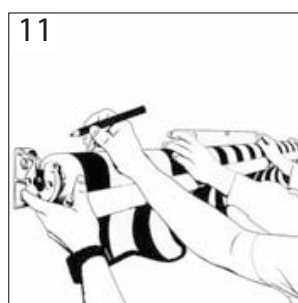
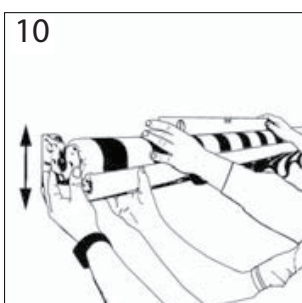
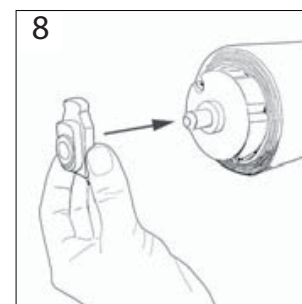
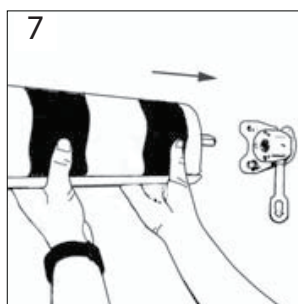
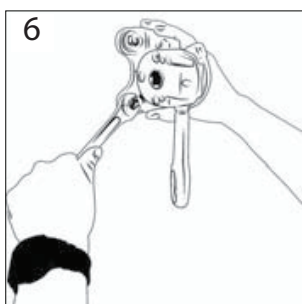
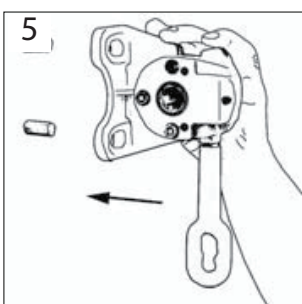
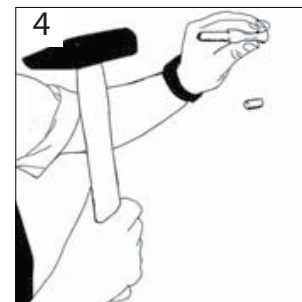
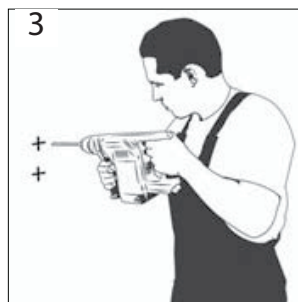
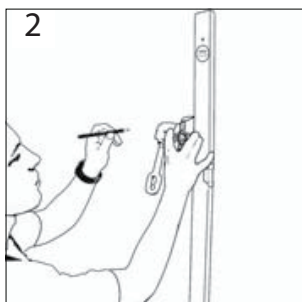
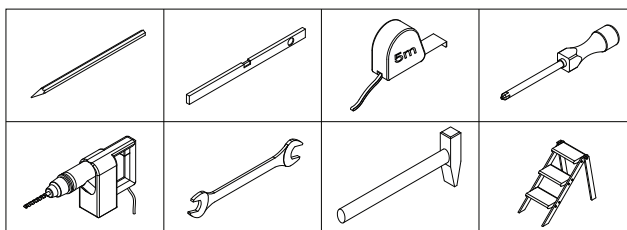

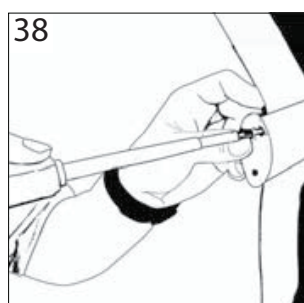
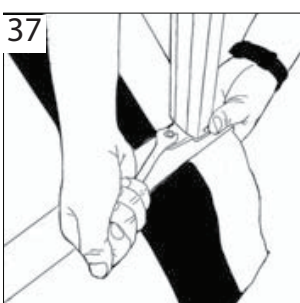
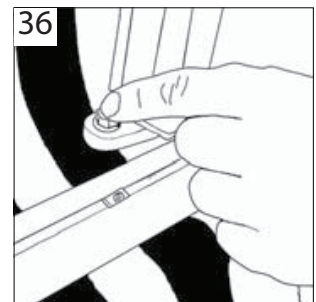
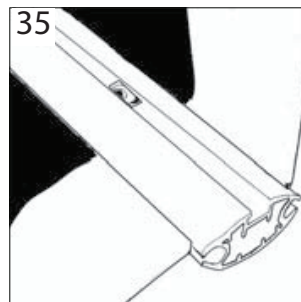
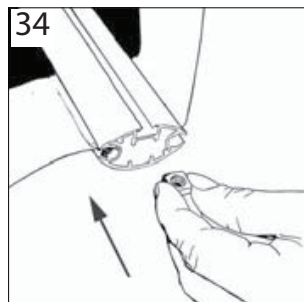
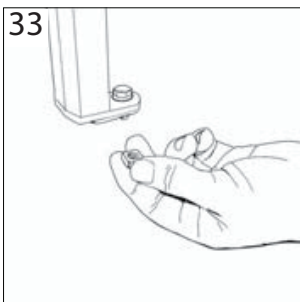
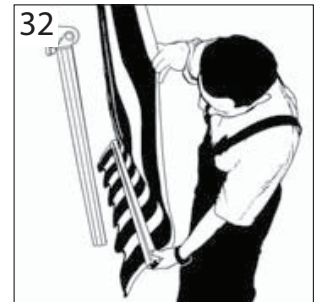
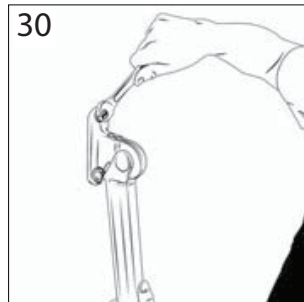
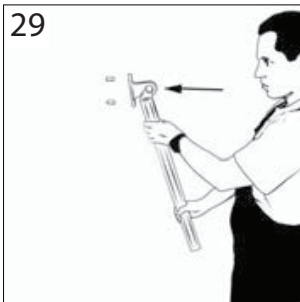
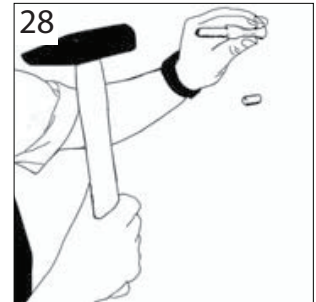
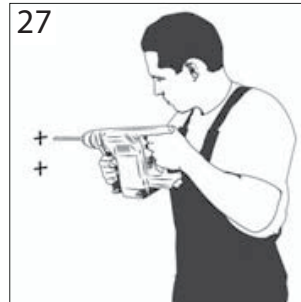
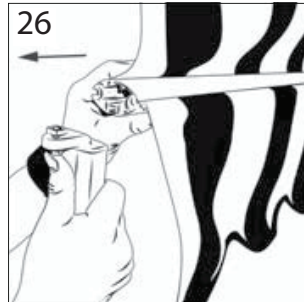
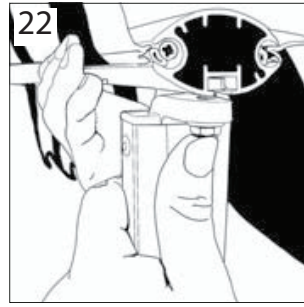
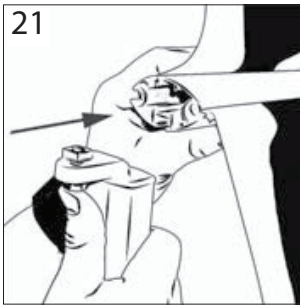

Typy držáků

